

**Tools Required**

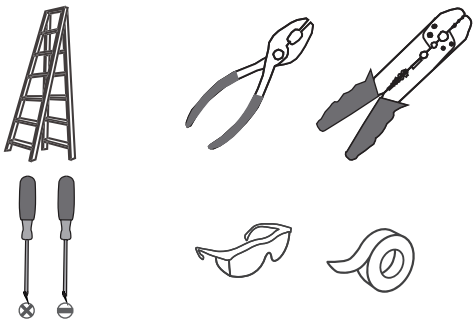

**Light Source**

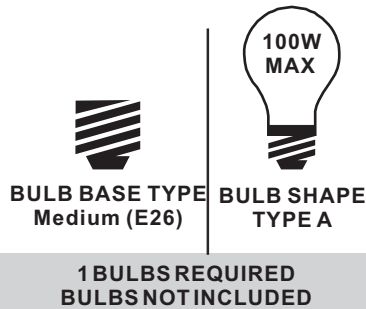

**Fixture Height Adjustable 22.25" to 58.25"**

**Warnings and Cautions**

Turn off the electricity at the circuit breaker before installation. Consult a licensed electrician if in doubt about installation.

Turn off power to the fixture and allow the bulbs to cool before replacing.

**Package Contents**

**Preparation:** Identify and inspect all parts before beginning the installation.

Missing or damaged parts? Contact your original place of purchase.

**PARTS BAG**

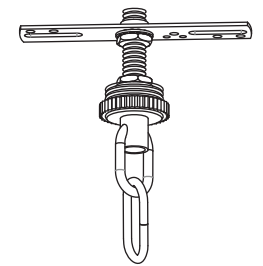

**A** Crossbar Assembly x 1

**B** Outlet Box Screw x 2

**C** Wire Connector x 3

**D** Quick Link x 1

**E** Ceiling Canopy x 1

**F** Small Loop x 1

**G** 6" L Rod x 2

**I** 12" L Rod x 2

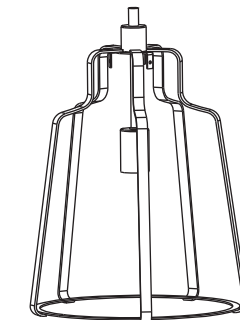

**H** Fixture Body x 1

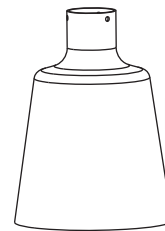

**J** Shade x 1

**K** Stem x 3

**Table of Contents**

Fixture Body	Rods & Small Loop	Crossbar Assembly	Quick Link	Wiring	Ceiling Canopy	Bulb
<b>STEP 1</b>	<b>STEP 1</b>	<b>STEP 2</b>	<b>STEP 3</b>	<b>STEP 4</b>	<b>STEP 5</b>	<b>STEP 6</b>

### STEP 1

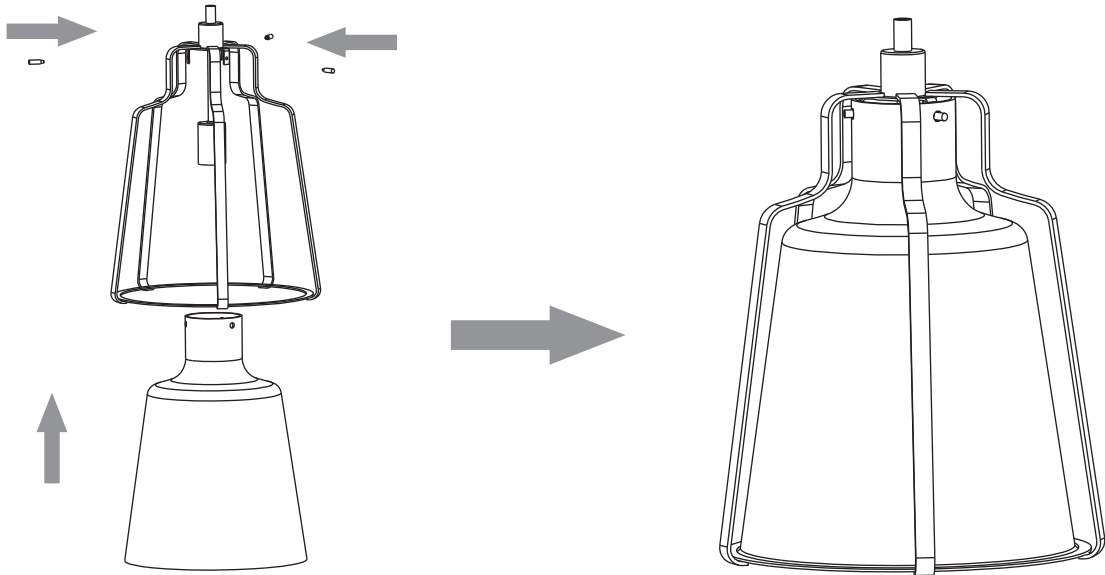

### STEP 2

**Optional Rods**

**8' ceiling:**  
(1) 6"L rods

**9' ceiling:**  
(1) 6"L + (1) 12"L rods

**10' ceiling:**  
(1) 6"L + (2) 12"L rods

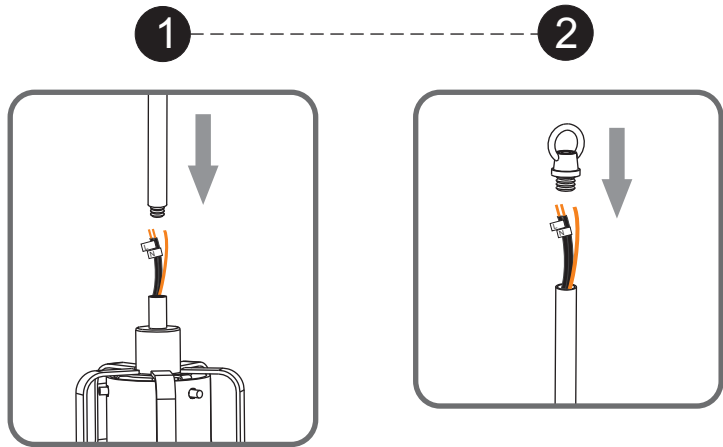

### STEP 3

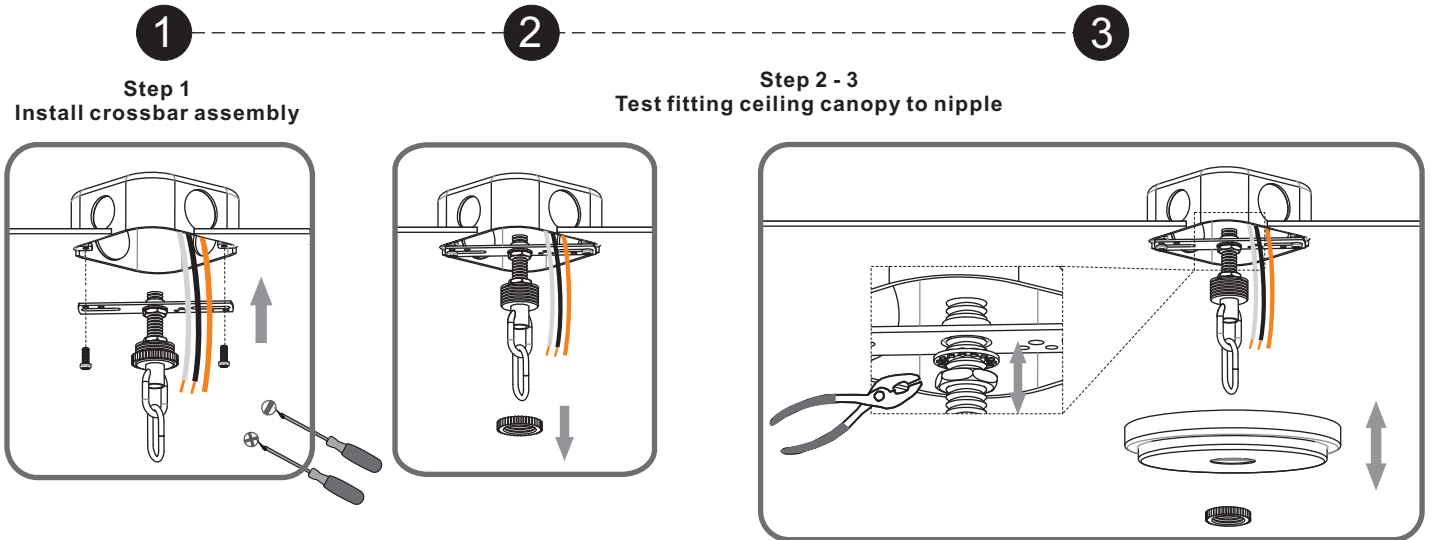

## STEP 4

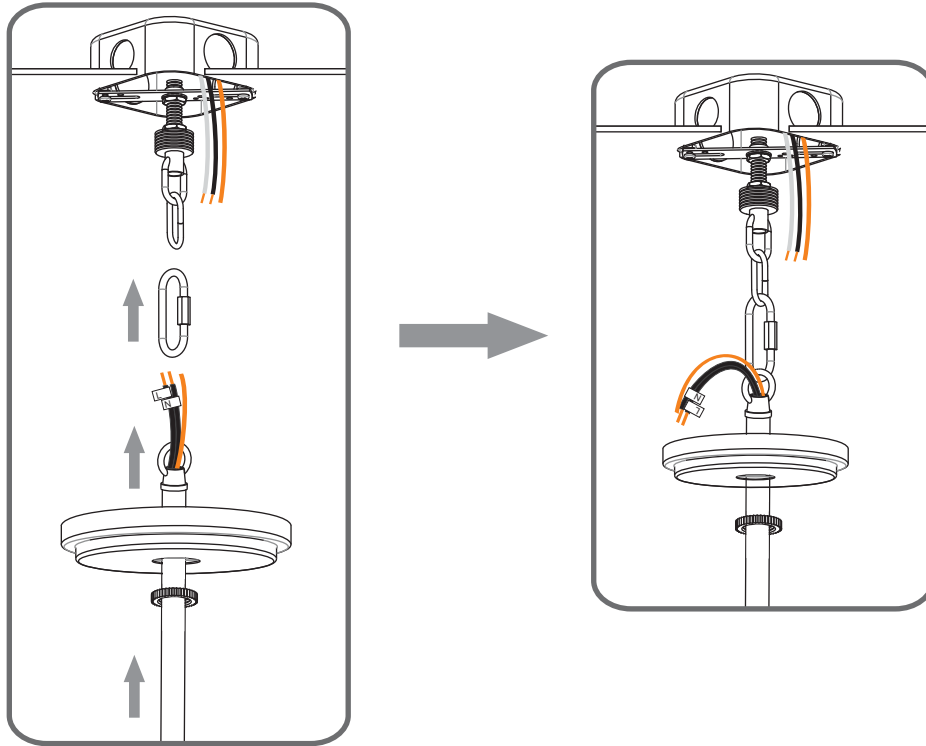

## STEP 5

1

**Step 1**  
Feed the fixture wires  
through the loop

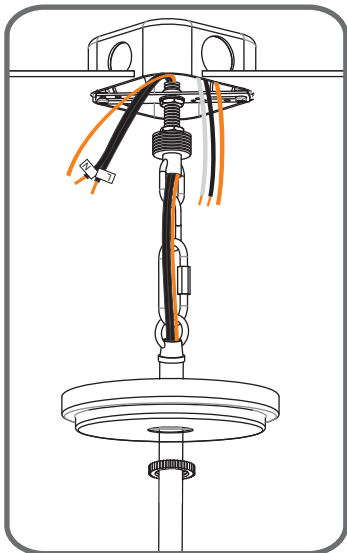

2

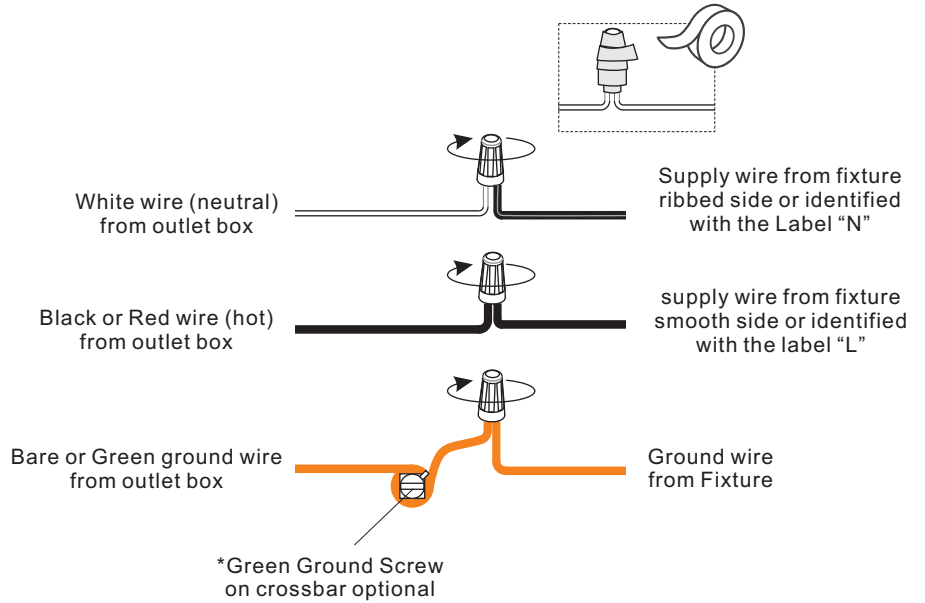

**STEP 6**

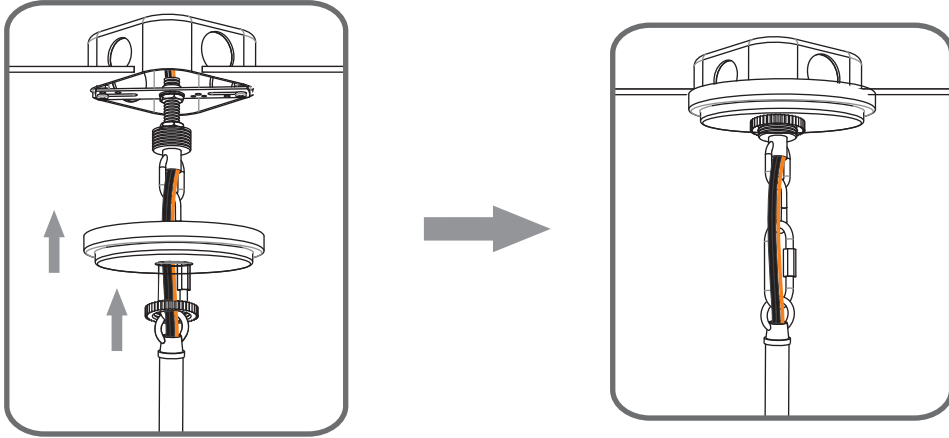

**STEP 7**

