

# PCIVT - LED SERIES

LED Extreme Environment

## Specifications:

### Features:

- LED Enclosed and Gasketed
- Long life 60,000 hour LEDs at L80 for reduced maintenance
- 4000 Lumens
- UL 5VA Fiberglass housing with F1 weatherability rating
- Gasket is non-porous
- Impact modified acrylic lens equivalent to 100% DR
- Lens firmly secured with tamper resistance ready polyacetal (POM) latches
- Removable gear tray electrical access for modular replaceability
- Standard ambient -20°C – 25°C
- Includes surface mounting brackets
- Universal input voltage, 120-277 VAC, 50/60 Hz

### Compliances:

PCIVT – LED Series are built to UL 1598 and 2108 standards, and bear appropriate CSA labels. Ingress protection IP65 and IP67 standard. ULSanitation certified to NSF standards. Wet location labeling is standard.

### Dimensions:

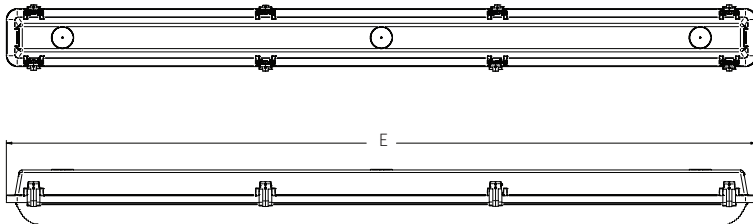

A	B	C	D	E
3 7/8"	4"	4 1/2"	2 3/8"	51 3/4"

### Images:



### Warranty:

5 year warranty (Terms and Conditions Apply)

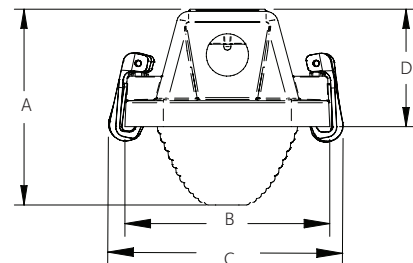

### Catalog number:

Base	Lamp Type	Size	Color Temperature
PCIVT	LED	4 - 4'	35K - 3500K

# PCIVT - LED SERIES

LED Extreme Environment

## Photometric Data:

PCIVT-47L-4-40	
Fixture Lumens	5383
Watts	47.00
Mounting	SURFACE
Shielding Angle	0° = 90 90° = 90
Spacing Criterion	0° = 1.25 90° = 1.30
Luminous Option (LxWxH)	4.25' x 0.50' x 0.33'

Zonal Lumen Summary PCIVT-47L-4-40

Zone	Lumens	% Lamp	%Fixt
0-30	1297	24.1	24.1
0-40	2127	39.5	39.5
0-60	3824	71.0	71.0
0-90	5150	94.8	94.8
0-180	6182	100.0	100.0

Energy Data PCIVT-47L-4-40

Total Luminance Efficiency	100.0%
Total Luminance per Watt	115
ANSI/IESNA RP-1-2004 Compliance	Noncompliant

INDOOR CANDELA PLOT

